

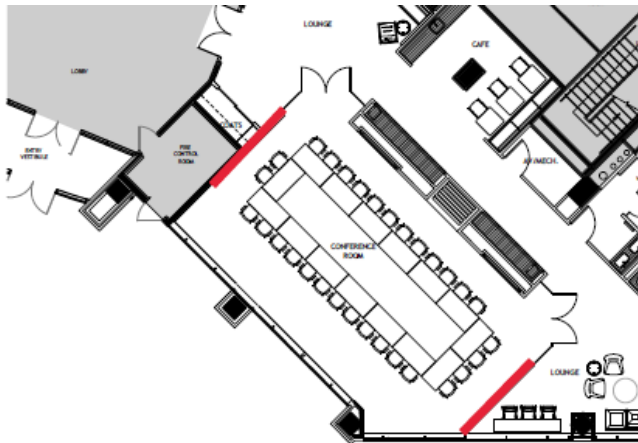

CONNECTING TO THE TV DISPLAYS

Chromecast



The 2 televisions on each end of the room (4 total) are equipped with Chromecast devices. To share your screen:

1. Open the Chrome browser.
2. At the top right, click **More**  **> Cast**
3. Click **Sources** .
4. Click **Cast desktop, Cast File** or **Cast Tab**.

ClickShare

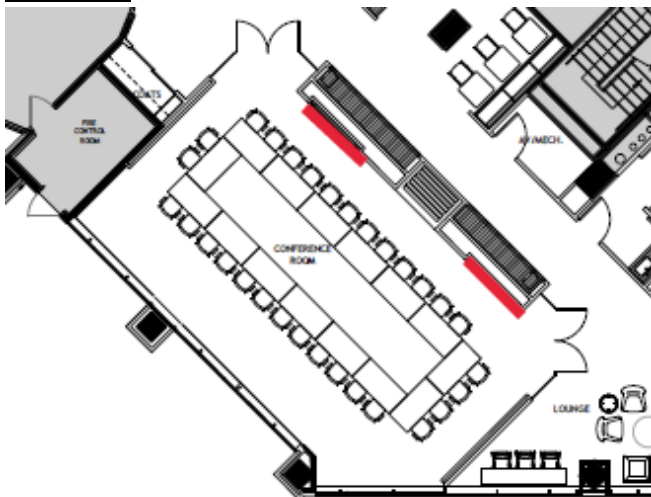

The 2 televisions facing the windows are equipped with ClickShare devices. To share your screen:

1. Plug the device into your laptop's USB port
2. Once inserted, you will notice the flashing white light surrounding the button. This indicates the ClickShare button has been recognized by your laptop.
3. A pop-up should appear in the bottom right of your screen. Click 'Ok.'
4. Once the ClickShare button is connected to the base unit, the flashing white ring on the button will turn solid white. Press the button to start sharing – it will then turn to a solid red indicating you are sharing your screen.

**Clickshare also has a desktop app that can be downloaded and can be used in lieu of the device.